

9000 (29.53')

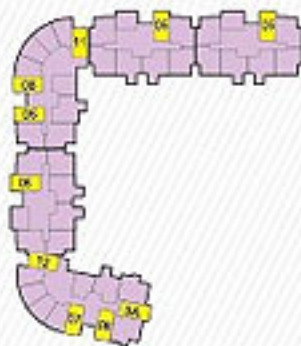

Type	Rooms	Built-up Area (sq.ft.)
JS40-D	Studio	Approx. 466
★ Built-up area during sales period is accordance to our tabled price list. Actual built-up area based on the floor plan subject to the authorities approval.		

All plans, specifications and information contained herein are subject to change without notification as may be required by the authorities/engineers/architect and the developer and cannot form part of any offer or contract.

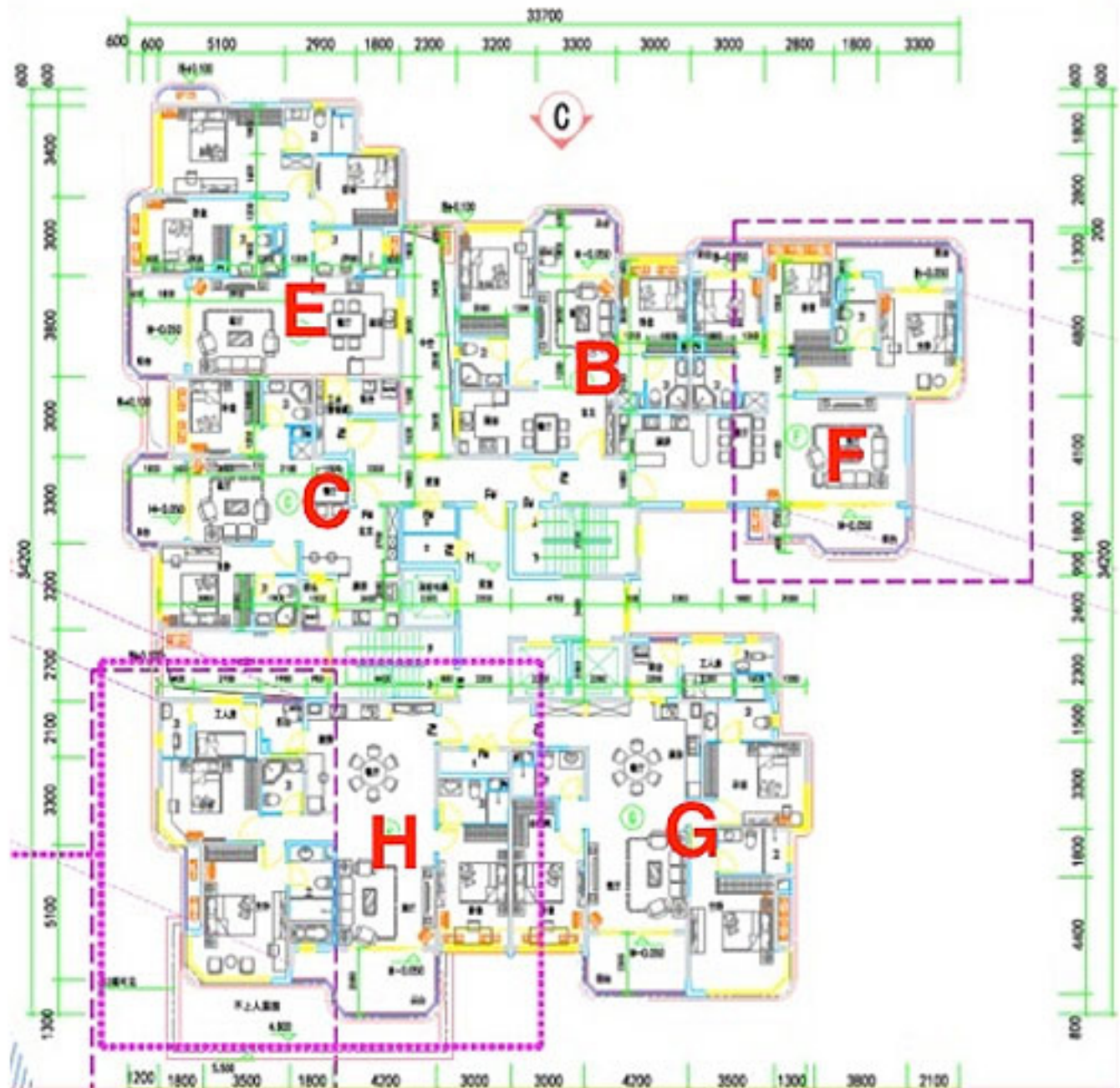



Type	Rooms	Built-up Area (sq. ft.)
J533-B	2 rooms	Approx. 814.83
★ Built-up area during sales period is accordance to our tabled price list. Actual built-up area based on the floor plan subject to the authorities approval.		

All plans, specifications and information contained herein are subject to change without notification as may be required by the authorities, engineer/architect and the developer and cannot form part of any offer or contract.

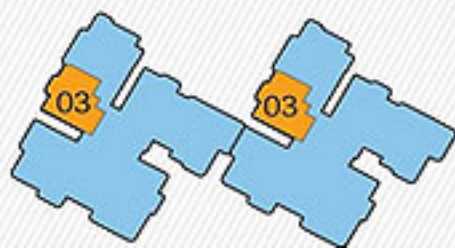

Type	Rooms	Built-up Area (sq.ft.)
J533-C	2 rooms	Approx. 879.41

★ Built-up area during sales period is accordance to our tabled price list. Actual built-up area based on the floor plan subject to the authorities approval.

All plans, specifications and information contained herein are subject to change without notification as may be required by the authorities, engineers/architect and the developer and cannot form part of any offer or contract.



Type	Rooms	Built-up Area (sq.ft.)
J533-E	3 rooms	Approx. 1231.39
★ Built-up area during sales period is accordance to our tabled price list. Actual built-up area based on the floor plan subject to the authorities approval.		

All plans, specifications and information contained herein are subject to change without notification as may be required by the authorities/engineer/architect and the developer and cannot form part of any offer or contract.



Type	Rooms	Built-up Area (sq.ft.)
J533-F	3 rooms	Approx. 1263.68
★ Built-up area during sales period is accordance to our tabled price list. Actual built-up area based on the floor plan subject to the authorities approval.		

All plans, specifications and information contained herein are subject to change without notification as long as required by the authorities/engineers/architect and the developer and cannot form part of any offer or contract.



Type	Rooms	Built-up Area (sq. ft.)
J533-G	3 rooms	Approx. 1425.14
★ Built-up area during sales period is according to our tabled price list. Actual built-up area based on the floor plan subject to the authorities approval.		

All plans, specifications, and information contained herein are subject to change without notification as may be required by the authorities/engineer/architect and the developer and cannot form part of any offer or contract.



Type	Rooms	Built-up Area (sq.ft.)
J533-H	3 rooms	Approx. 1473.58

* Built-up area during sales period is accordance to our tabled price list. Actual built-up area based on the floor plan subject to the authorities approval.

All plans, specifications and information contained herein are subject to change without notification as may be required by the authorities, engineer/architect and the developer and cannot form part of any offer or contract.



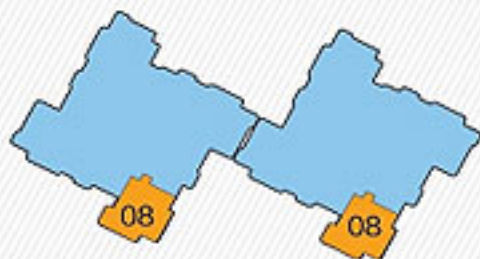

Type	Rooms	Built-up Area (sq.ft.)
J535-A	3 rooms	Approx. 1186.18

* Built-up area during sales period is accordance to our tabled price list. Actual built-up area based on the floor plan subject to the authorities approval.

All plans, specifications, and information contained herein are subject to change without notification as may be required by the authorities, engineer/architect and the developer and cannot form part of any offer or contract.



Type	Rooms	Built-up Area (sq.ft.)
J535-B	2 rooms	Approx. 814.83
★ Built-up area during sales period is accordance to our tabled price list. Actual built-up area based on the floor plan subject to the authorities approval.		

All plans, specifications, and information contained herein are subject to change without notification as may be required by the authorities (engineers, architect) and the Developer and cannot form part of any offer or contract.

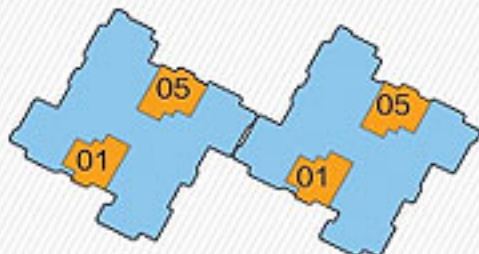

Type	Rooms	Built-up Area (sq.ft.)
J535-C	2 rooms	Approx. 880.49
★ Built-up area during sales period is accordance to our tabled price list. Actual built-up area based on the floor plan subject to the authorities approval.		

All plans, specifications and information contained herein are subject to change without notification as may be required by the authorities/engineers/architect and the developer and cannot form part of any offer or contract.



Type	Rooms	Built-up Area (sq.ft.)
J535-D	3 rooms	Approx. 3242.16
★ Built-up area during sales period is accordance to our tariff price list. Actual built up area based on the floor plan subject to the authorities approval.		

All plans, specifications and information contained herein are subject to change without notification as may be required by the authorities, engineer, architect and the developer and cannot form part of any offer or contract.



Type	Rooms	Built-up Area (sq.ft.)
J535-E	3 rooms	Approx. 1234.62
* Built-up area during sales period is accordance to our tabbed price list. Actual built-up area based on the floor plan subject to the authorities approval.		

All plans, specifications and information contained herein are subject to change without notification as may be required by the authorities/engineer/architect and the developer and cannot form part of any offer or contract.

FLOOR PLAN J540-A



Type	Rooms	Built-up Area (sq.ft.)
J540-A	2 rooms	Approx. 698.58
★ Built up area during sales period is accordance to our talked price list. Actual built-up area based on the floor plan subject to the authorities approval.		

All plans, specifications and information contained herein are subject to change without notification as may be required by the authorities, engineer/architect and the developer and cannot form part of any offer or contract.



Type	Rooms	Built-up Area (sq.ft.)
J540-B	2 rooms	Approx. 721.18
<p>★ Built-up area during sales period is accordance to our tabled price list. Actual built-up area based on the floor plan subject to the authorities approval.</p>		

All plans, specifications and information contained herein are subject to change without notification as may be required by the authorities/engineers/architect and the Developer and cannot form part of any offer or contract.



Type	Rooms	Built up Area (sq.ft.)
J540-C	1 room	Approx. 406.88
<p>★ Built up area during sales period is accordance to our talked price list. Actual built up area based on the floor plan subject to the authorities approval.</p>		

All plans, specifications and information contained herein are subject to change without notification as may be required by the authorities/engineer/architect and the developer and cannot form part of any offer or contract.

4800 (15.75')

9000 (29.53')



Type	Rooms	Built-up Area (sq.ft.)
J540-D	Studio	Approx. 455.31
★ Built-up area during sales period is accordance to our tabled price list. Actual built-up area based on the floor plan subject to the authorities approval.		

All plans, specifications and information contained herein are subject to change without notification as may be required by the authorities (engineers/architects) and the Developer and (cannot) form part of any offer or contract.



Type	Rooms	Built-up Area (sq. ft.)
J540-E	1 room	Approx. 468.23
* Built-up area during sales period is accordance to our tabbed price list. Actual built up area based on the floor plan subject to the authorities approval.		

All plans, specifications, and information contained herein are subject to change without notification as may be required by the authorities/engineers/architect and the Developer and cannot form part of any offer or contract.



Type	Rooms	Built-up Area (sq.ft.)
J540-F	1 room	Approx. 469.31
★ Built-up area during sales period is accordance to our tabulated price list. Actual built-up area based on the floor plan subject to the authorities approval.		

All plans, specifications and information contained herein are subject to change without notification as may be required by the authorities/engineer/architect and the developer and cannot form part of any offer or contract.