

TYPE C3

LEVEL 9-33

Built-up area : 139.4 sq.m (1,500 sq.ft.)

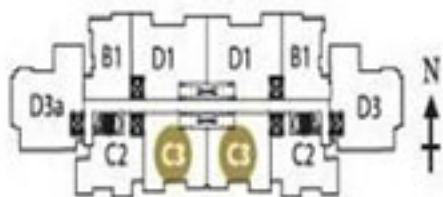



TYPE C2 LEVEL 8-33
 Built-up area : 110.5 sq. m (1,189 sq. ft.)

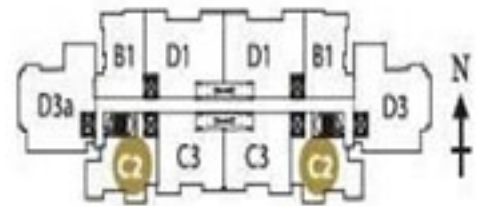

TYPE B1

LEVEL 8-33 ▶

Built-up area : 117.72 sq.m (1,267 sq.ft.)

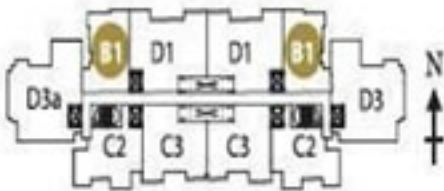



◀ **TYPE D3a (LEFT)** LEVEL 7-33
Built-up area : 185.12 sq.m (1,993 sq.ft.)

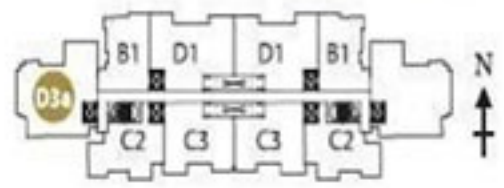

TYPE D3

LEVEL 7-33

Built-up area : 187.92 sq.m (2,023 sq.ft.)

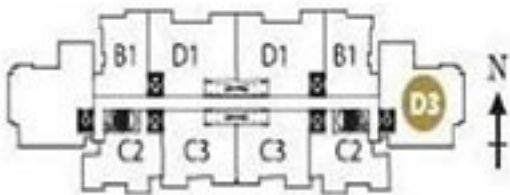



◀ **TYPE D1** LEVEL 9-33
 Built-up area : 172.6 sq/m (1,858 sq.ft.)

