

Builder of Distinction  
**Setia**  
S P SETIA BHD GROUP



MALAYSIA | VIETNAM | AUSTRALIA | SINGAPORE | CHINA | INDONESIA | UNITED KINGDOM

S P Setia International (S) Pte Ltd  
1 Harbourfront Place #01-06,  
Harbourfront Tower One, Singapore 098633.

**livelearnworkplay**  
[www.spsetia.com.my](http://www.spsetia.com.my)

+65 6271 2255  
Email: [sg-sales@spsetia.com.sg](mailto:sg-sales@spsetia.com.sg)



• Developer – S P Setia International (S) Pte Ltd (UEN 200906303E) • Developer License No. – CD983 • Tenure of Land – 99 Year wef 25 April 2012 • Location – Lot 2595V, MK 16, at Chestnut Avenue  
• Expected Date of TOP – 31 December 2016 • Expected Date of Legal Completion – 31 December 2019 • Building Plan Approval No. A0781-00005-2012-BP01 dated 08 November 2012  
All information, plans and specifications are current at the time of print and are subject to changes as may be required or approved by the developer or the relevant authorities. The Sale and Purchase Agreement shall form the entire agreement between the developer and the purchaser and shall in no way be modified by any statements or representations (whether contained in this brochure or otherwise).

**TYPE B2p**  
**2 - BEDROOM**  
 89 sq.m. (958 sq.ft.)

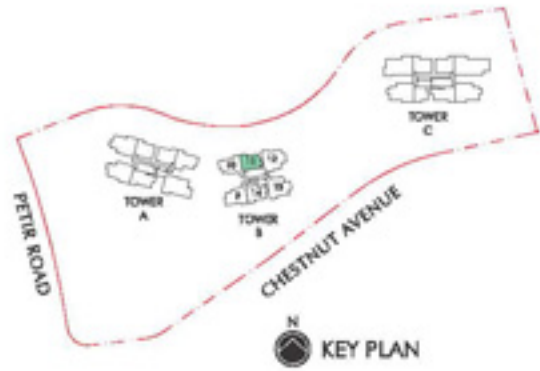

Applicable to unit:  
 #01-11

**TYPE B2**  
**2 - BEDROOM**  
 65 sq.m. (700 sq.ft.)

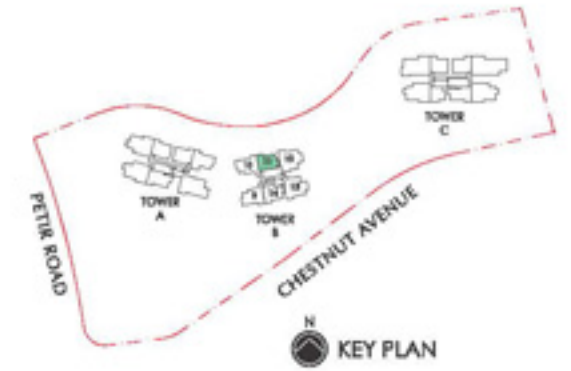

Applicable to units:  
 #02-11, #04-11, #06-11, #08-11, #10-11, #12-11,  
 #15-11, #17-11, #19-11, #21-11, #23-11



Applicable to units:  
 #03-11, #05-11, #07-11, #09-11, #11-11, #13-11,  
 #16-11, #18-11, #20-11, #22-11, #24-11

## TYPE B2ap 2 - BEDROOM

89 sq.m. (958 sq.ft.)



Applicable to unit:  
#01-14

## TYPE B2a 2 - BEDROOM

65 sq.m. (700 sq.ft.)



Applicable to units:  
#03-14, #05-14, #07-14, #09-14, #11-14, #13-14,  
#16-14, #18-14, #20-14, #22-14, #24-14



Applicable to units:  
#02-14, #04-14, #06-14, #08-14, #10-14, #12-14,  
#15-14, #17-14, #19-14, #21-14, #23-14

## TYPE BS2ap 2 - BEDROOM + STUDY

99 sq.m. (1066 sq.ft.)



Applicable to units:  
#01-09  
#01-10 (mirror)

The plan is not to scale and subject to change as may be approved by the relevant authorities.  
All floor areas are approximate and subject to final survey.

## TYPE BS2a 2 - BEDROOM + STUDY

72 sq.m. (775 sq.ft.)



Applicable to units:  
#03-09, #05-09, #07-09, #09-09, #11-09, #13-09,  
#16-09, #18-09, #20-09, #22-09, #24-09

Applicable to units (mirror):  
#03-10, #05-10, #07-10, #09-10, #11-10, #13-10,  
#16-10, #18-10, #20-10, #22-10, #24-10

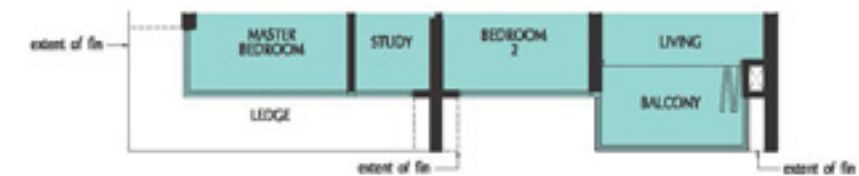

Applicable to units:  
#02-09, #04-09, #06-09, #08-09, #10-09, #12-09,  
#15-09, #17-09, #19-09, #21-09, #23-09

Applicable to units (mirror):  
#02-10, #04-10, #06-10, #08-10, #10-10, #12-10,  
#15-10, #17-10, #19-10, #21-10, #23-10

The plan is not to scale and subject to change as may be approved by the relevant authorities.  
All floor areas are approximate and subject to final survey.

**TYPE C1p**  
**3 - BEDROOM**  
 122 sq.m. (1313 sq.ft.)

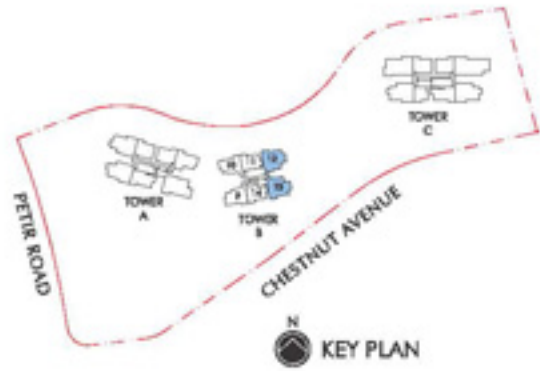

Applicable to units:  
 #01-12  
 #01-13 (mirror)

**TYPE C1**  
**3 - BEDROOM**  
 91 sq.m. (980 sq.ft.)

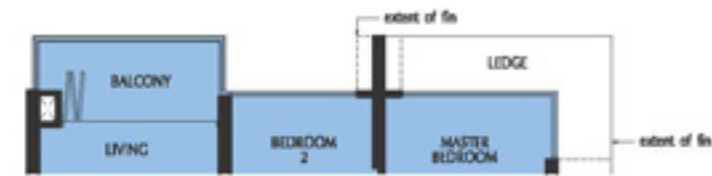
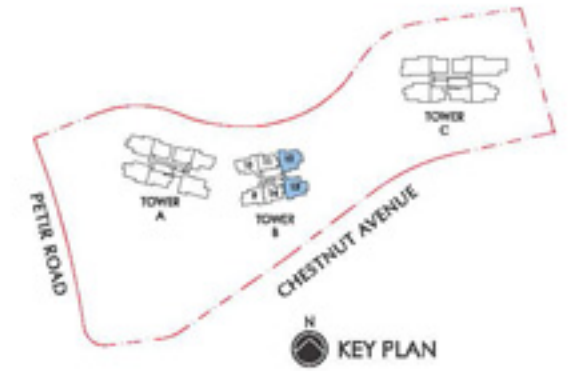

Applicable to units:  
 #02-12, #04-12, #06-12, #08-12, #10-12, #12-12,  
 #15-12, #17-12, #19-12, #21-12, #23-12

Applicable to units (mirror):  
 #02-13, #04-13, #06-13, #08-13, #10-13, #12-13,  
 #15-13, #17-13, #19-13, #21-13, #23-13

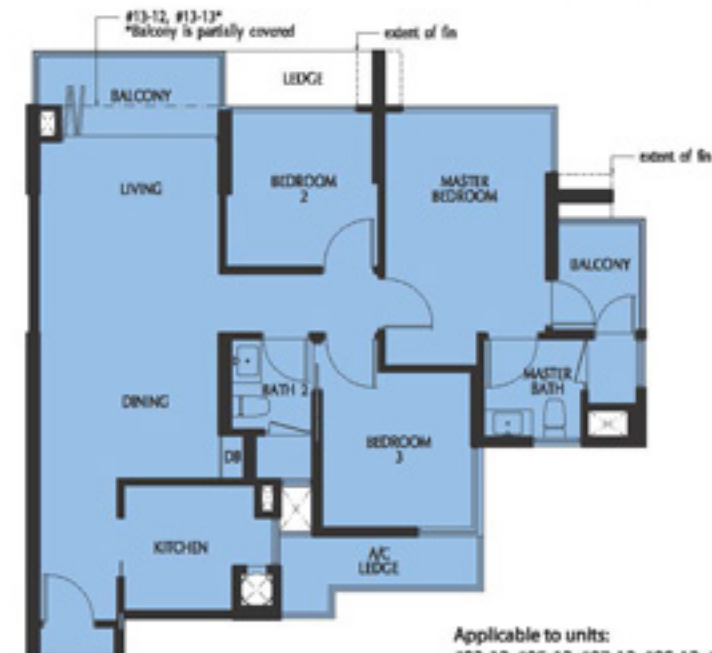

Applicable to units:  
 #03-12, #05-12, #07-12, #09-12, #11-12,  
 #13-12, #16-12, #18-12, #20-12, #22-12

Applicable to units (mirror):  
 #03-13, #05-13, #07-13, #09-13, #11-13,  
 #13-13, #16-13, #18-13, #20-13, #22-13

# TYPE C1r

## 3 - BEDROOM

149 sq.m. (1604 sq.ft.)



Applicable to units:  
#24-12  
#24-13 (mirror)

The plan is not to scale and subject to change as may be approved by the relevant authorities.  
All floor areas are approximate and subject to final survey.

END.