

TYPE A1

Unit #02-02 to #07-02
Area 42 sqm/ 452 sq ft
(Inclusive of Balcony)

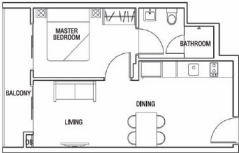

BALCONY TYPE

Tinted glass railing
#04-02, #05-02, #06-02

Parapet Wall
#02-02, #03-02, #07-02



TYPE A2

Unit #02-03 to #07-03

Area 43 sqm/ 463 sq ft

(Inclusive of Balcony & A/C Ledge)

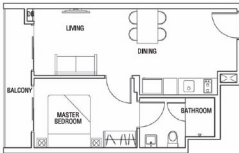

BALCONY TYPE

Tinted glass railing
#02-03, #03-03, #07-03

Parapet Wall
#04-03, #05-03, #06-03



TYPE A3

Unit #02-04 to #07-04

Area 44 sqm/ 474 sq ft

(Inclusive of Balcony & A/C Ledge)



BALCONY TYPE

Tinted glass railing
#04-04, #05-04, #06-04

Parapet Wall
#02-04, #03-04, #07-04



TYPE B2

Unit #02-06 to #07-06

Area 42 sqm/ 452 sq ft

(Inclusive of Balcony & A/C Ledge)



BALCONY TYPE

Tinted glass railing

#02-06, #03-06, #07-06

Parapet Wall

#04-06, #05-06, #06-06



TYPE C

Unit #02-01 to #07-01
Area 40 sqm/ 431 sq ft
(Inclusive of Balcony)



BALCONY TYPE

Tinted glass railing
#02-01, #03-01, #06-01, #07-01

Parapet Wall
#04-01, #05-01

